

GESTURE PROJECT

RACHAEL GAUTIER FALL 2020

THE CONCEPT OF THIS PROJECT WAS TO MARK PAPER USING A PHYSICAL GESTURE AND THEN TURN SAID GESTURE IN TO A TOPOGRAPHY FOLLOWED BY SITE DESIGN OF THIS TOPOGRAPHY.

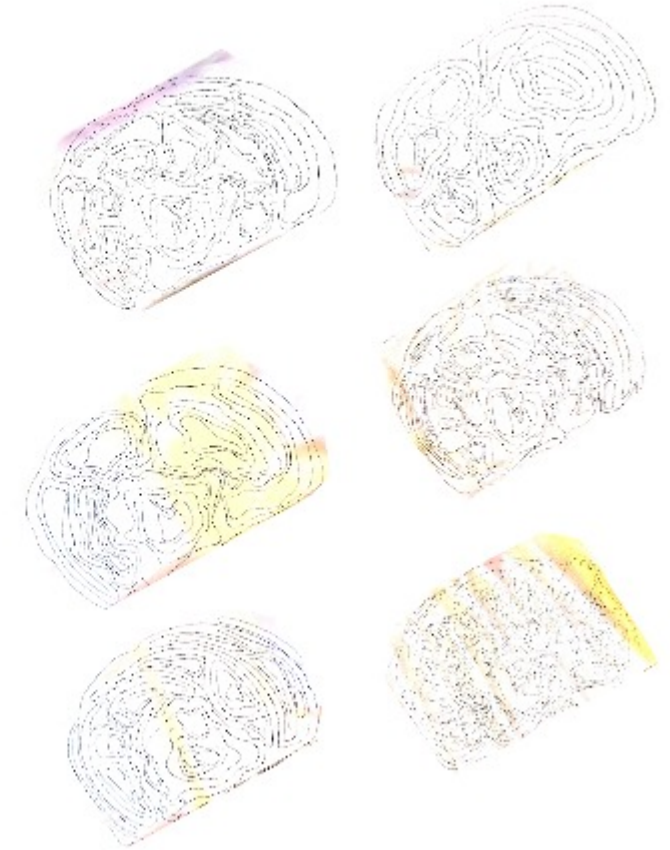
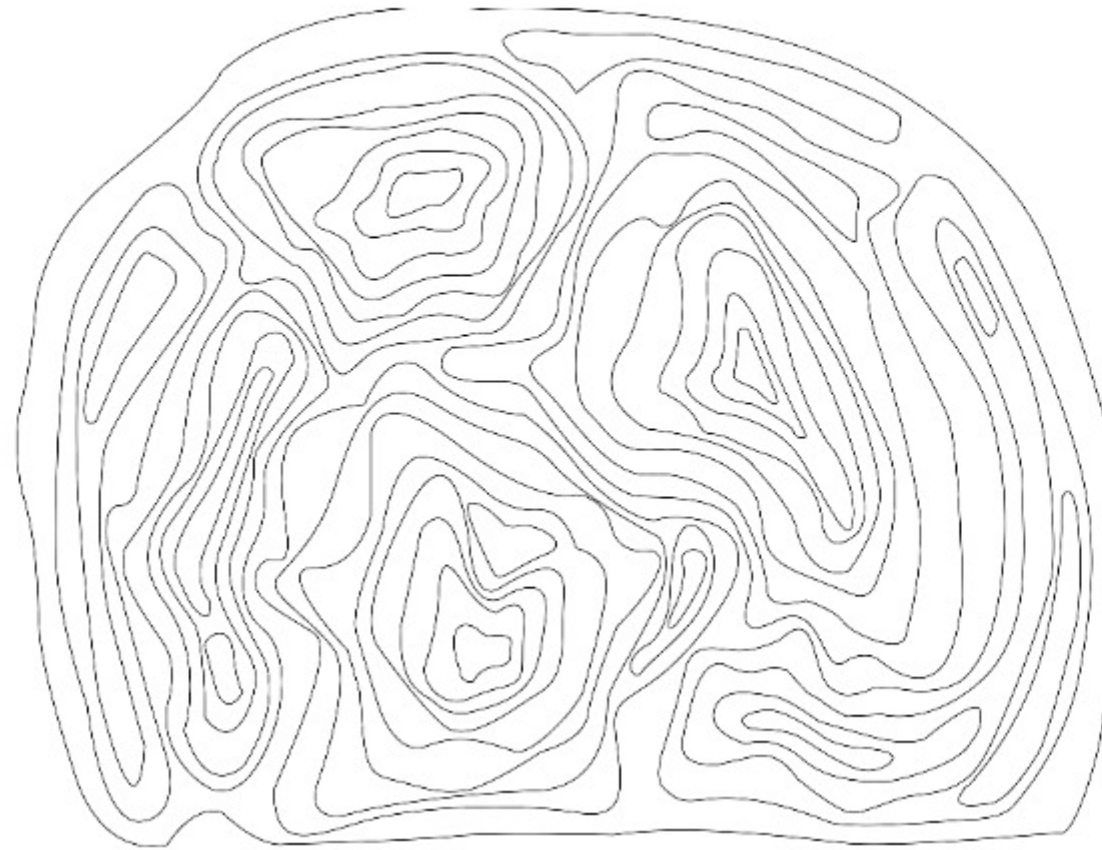

TOPOGRAPHIC MAP WAS FORMED BY LAYING TRACE OVER GESTURES AND FINDING DOMINANT SHAPES

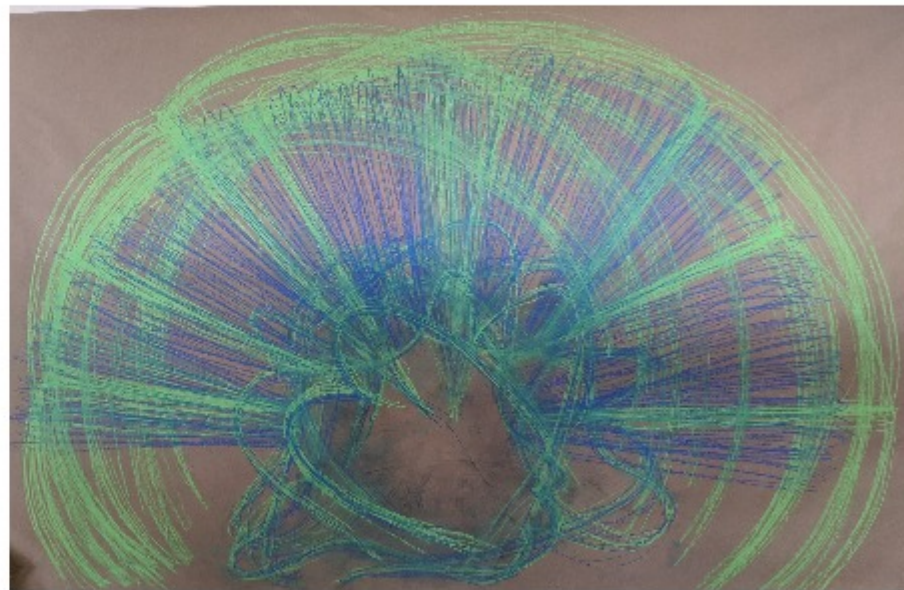

TO CREATE THIS PATTERN I TRACED MY KNEES IN CHILD'S POSE AND THE HELD MARK MAKERS WHILE EXTENDING MY ARMS

GESTURE PROJECT

CARBOARD MODELLING AND PATH EXPLORATION

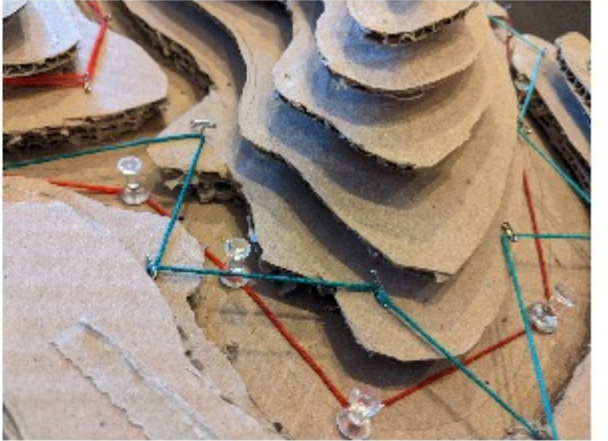
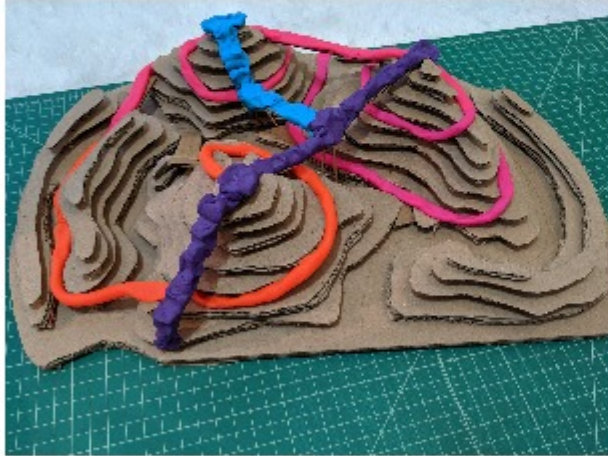

EXPERIENTIAL AND ENVIRONMENTAL EXPLORATION THROUGH MONTAGE

GESTURE PROJECT

REFLECTIVE THEMATIC STATEMENT

Smallness and openness, stillness and movement. These are two sets of opposites that are deeply connected. One cannot exist without the other, particularly in the case of my gesture.

My design and topography fully express this fluctuation. Bridges hang above both pathways and waterways, giving the visitor the opportunity to experience valleys and heights. It is my hope that anyone who visits this site will leave feeling both peaceful and exhilarated.

FINAL DESIGN PLAN



CHIPBOARD MODEL

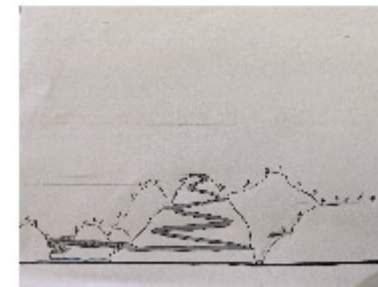
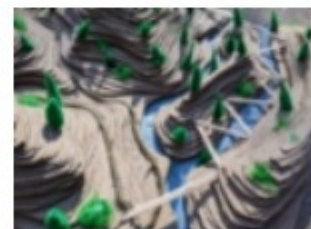
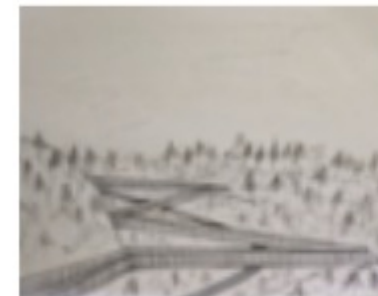

PATTERN PROJECT

RACHAEL GAUTIER FALL 2020

THE CONCEPT OF THE PATTERN PRODUCT WAS TO DESIGN A UNIQUE AND REPEATABLE SHAPE AND USE THAT SHAPE TO CREATE PATTERNS AND EVENTUALLY A SITE PLAN FOR A SMALL PARK.

EXPLORATION THROUGH DIGITAL PATTERNING AND TRACE PAPER

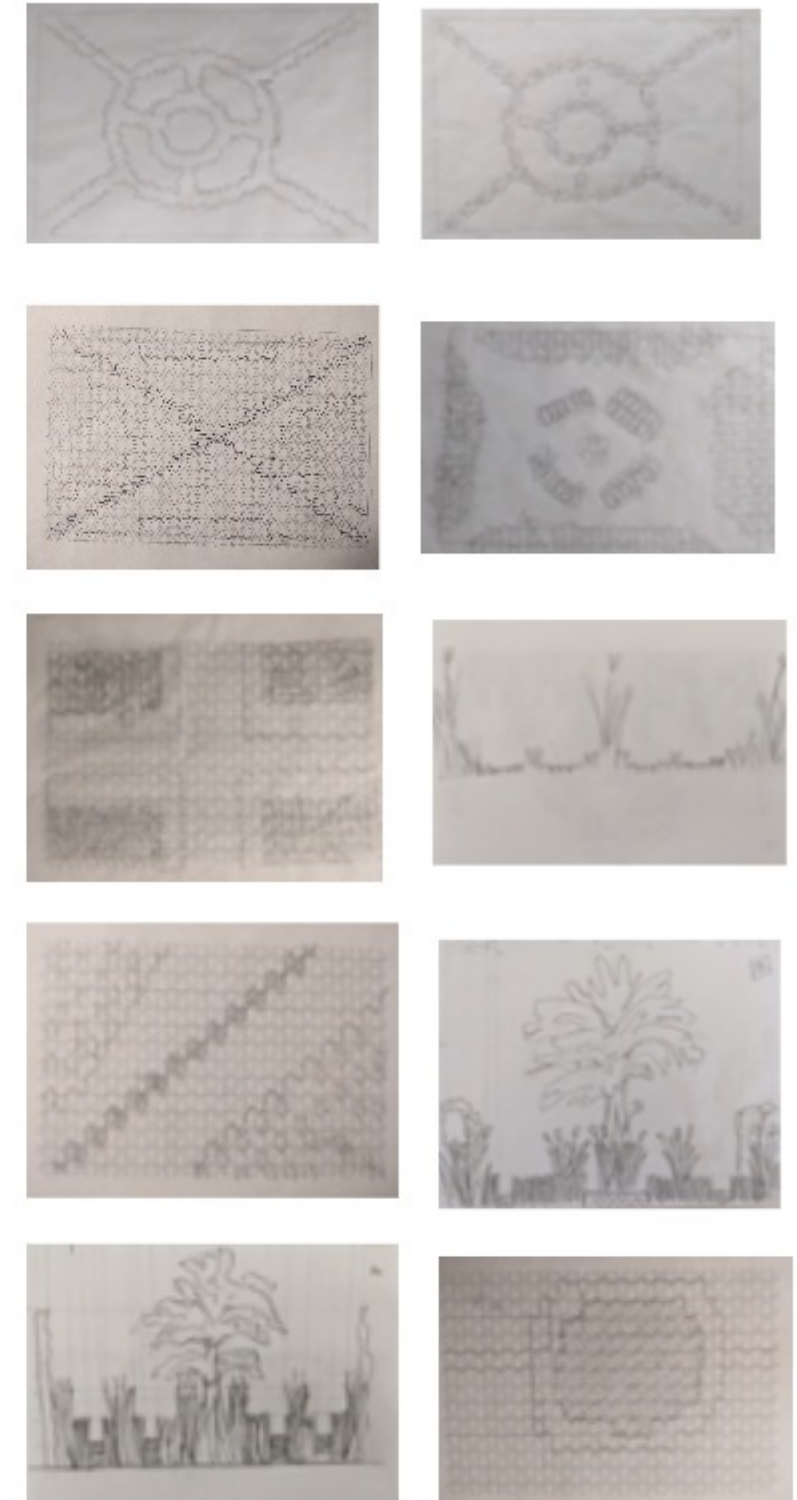
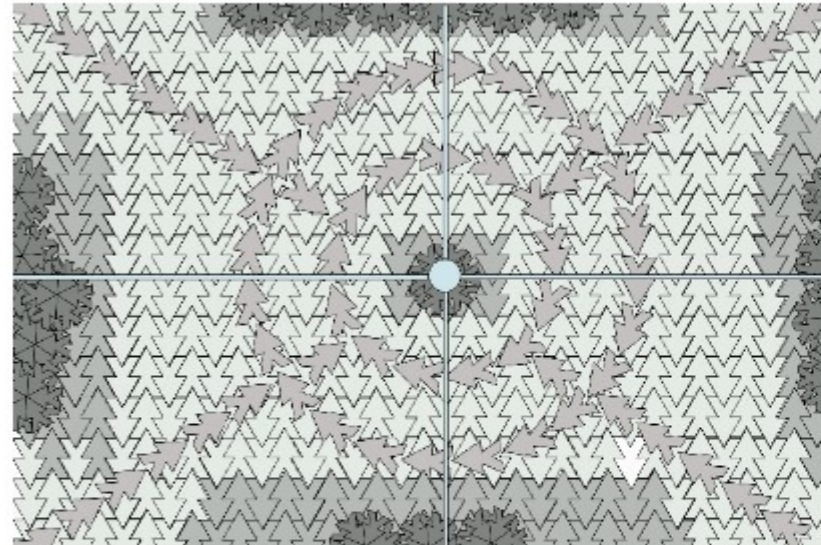
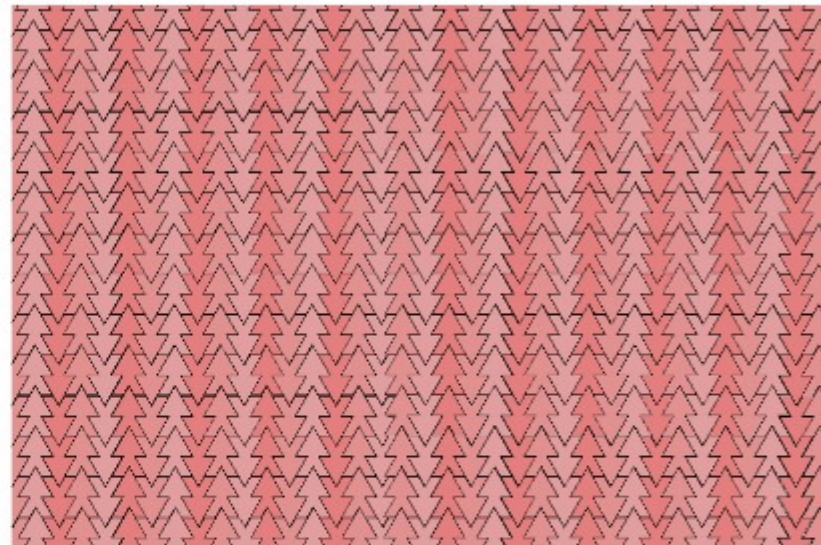
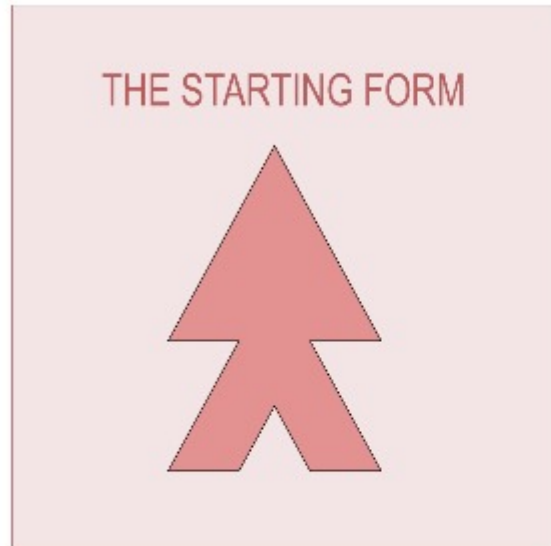

PATTERN PROJECT

FINAL DESIGN

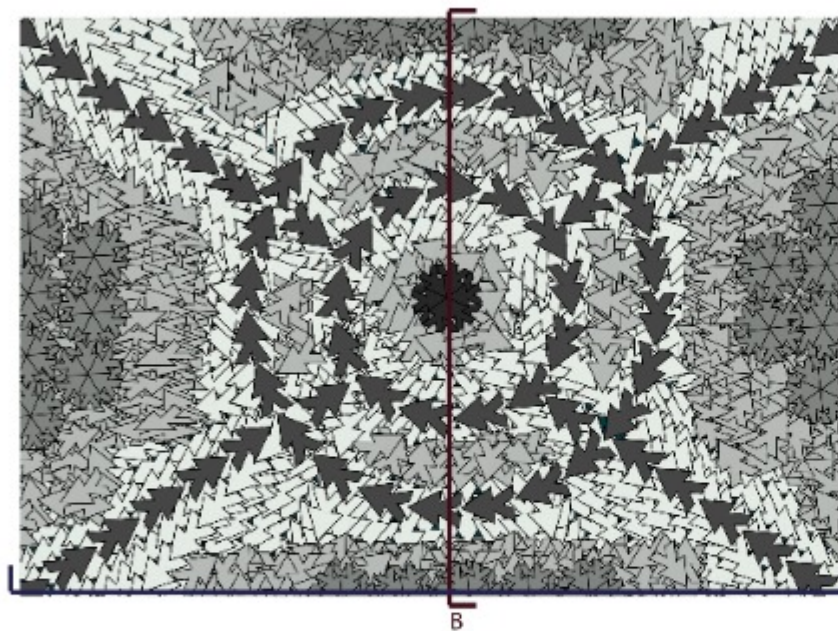
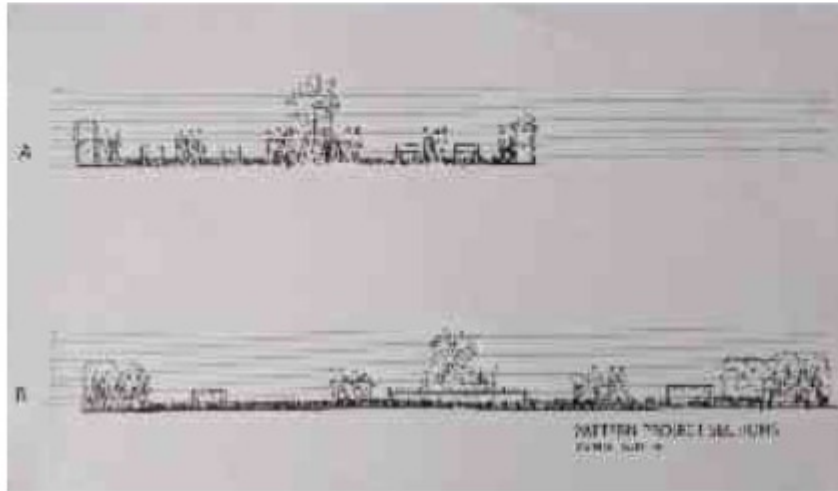

- RAISED WOOD PATHWAY 3'-0"
- WETLAND GRASS 1'-0"
- TALL GRASS/ REEDS 4'-0"
- SHRUBS 7'-0"
- YOUNG CYPRESS 11'-0"

* SUB GRADE IS NOT INDICATED BECAUSE THE SITE IS WETLAND (COVERED ENTIRELY IN WATER)*

PERMEABILITY DIAGRAM

